

REMOVAL

1. REMOVE THESE PARTS:

- (a) Front pillar garnishes
 - (b) Front door scuff plates
 - (c) Steering wheel
- (See page [SR-11](#))

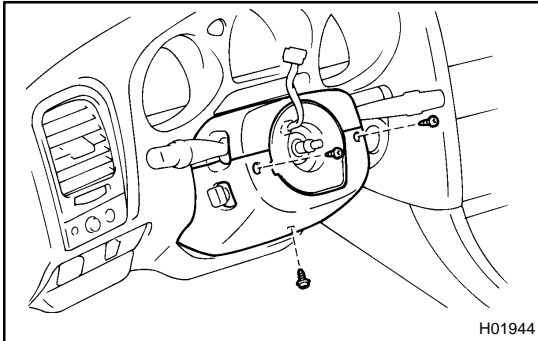

2. REMOVE STEERING COLUMN COVER

- (a) Remove the 3 screws.
- (b) Remove the steering column covers.

3. REMOVE COMBINATION SWITCH

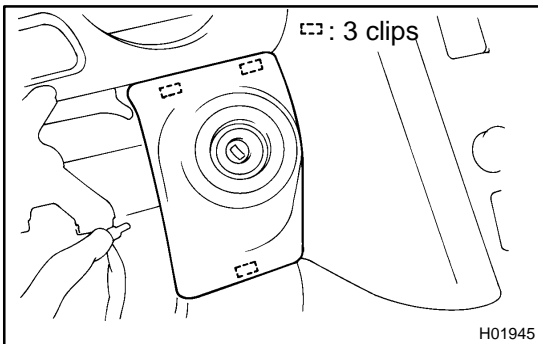

4. REMOVE END PAD

Using a screwdriver, remove the end pad.

HINT:

Tape the screwdriver tip before use.

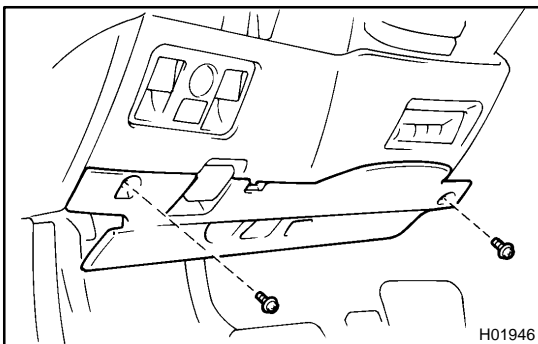

5. REMOVE NO. 1 UNDER COVER

- (a) Remove the 2 screws.
- (b) Remove the No. 1 under cover.

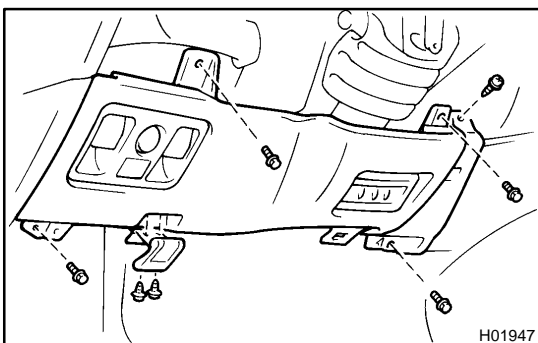

6. REMOVE NO. 1 SAFETY PAD

- (a) Remove the 2 screws and hood lock control.
- (b) Remove the 4 bolts and screw.
- (c) Remove the No. 1 safety pad.

7. REMOVE PARKING BRAKE HANDLE

8. REMOVE NO. 1 SWITCH HOLE BASE

9. REMOVE STEERING COLUMN

- (a) Remove the 4 nuts.
Torque: 25 N·m (250 kgf-cm, 19 ft-lbf)
- (b) Disconnect the spring from the brake pedal.
- (c) Remove the steering column.

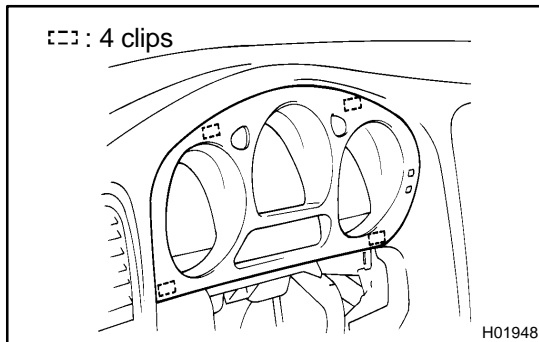
**10. REMOVE CLUSTER FINISH PANEL**

HINT:

Tape the screwdriver tip before use.

11. REMOVE COMBINATION METER

- (a) Remove the 4 screws.
- (b) Remove the meter, then disconnect the connectors.

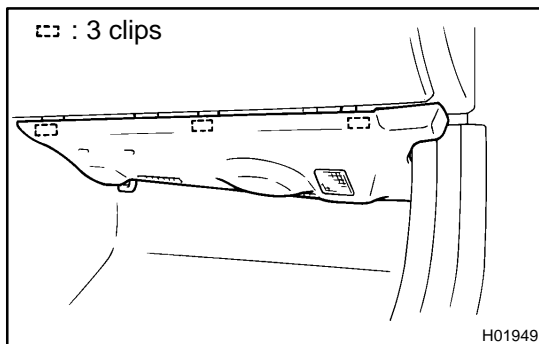
**12. REMOVE NO. 2 UNDER COVER**

Using a screwdriver, remove the No. 2 under cover.

HINT:

Tape the screwdriver tip before use.

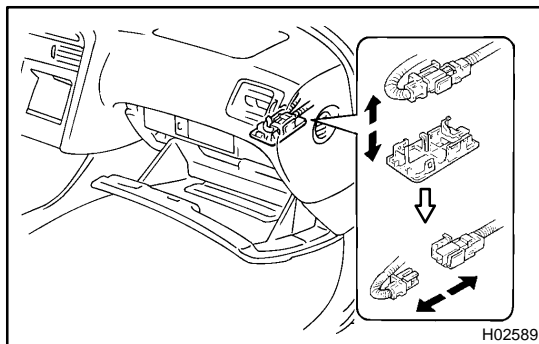
**13. DISCONNECT AIRBAG CONNECTOR****NOTICE:****When handling the airbag connector, take care not to damage the airbag wire harness.**

- (a) Remove the airbag connector from the plate.
- (b) Disconnect the airbag connector.

14. REMOVE GLOVE COMPARTMENT PANEL ASSEMBLY

- (a) Remove the 2 bolts.
- (b) Open the glove compartment door, then remove the 3 screws.
- (c) Remove the glove compartment panel assembly.

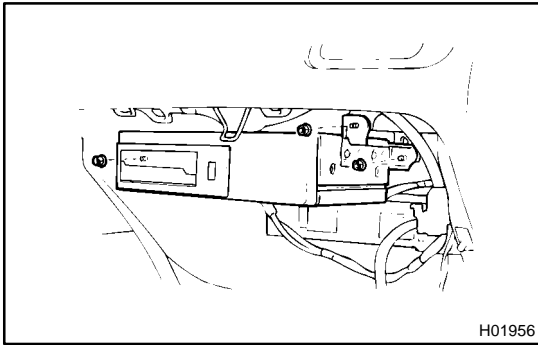
**15. REMOVE CD CHANGER**

- (a) Remove the 3 nuts.
- (b) Disconnect the connector and remove the CD changer bracket.

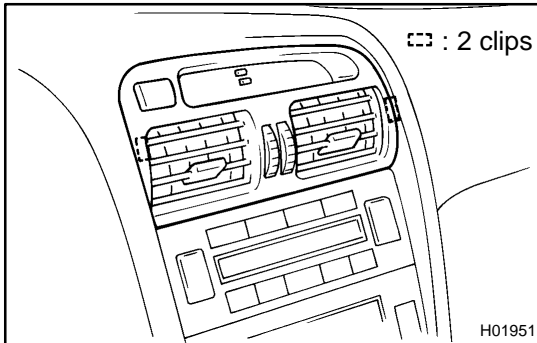
16. REMOVE ASH RECEPTACLE**17. REMOVE NO. 2 REGISTER**

- (a) Using a screwdriver, remove the No. 2 register.

HINT:

Tape the screwdriver tip before use.

- (b) Disconnect the connector.

18. REMOVE AUDIO

- (a) Remove the 2 bolts and 2 screws.
- (b) Disconnect the connector, then remove the audio.

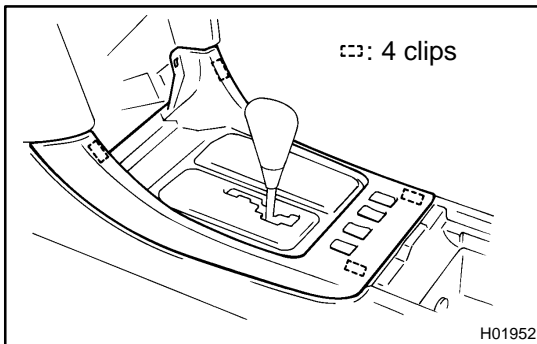
**19. REMOVE CLUSTER FINISH PANEL**

- (a) Using a screwdriver, pry out the cluster finish panel.

HINT:

Tape the screwdriver tip before use.

- (b) Disconnect the connectors.

20. REMOVE THESE PARTS:

- (a) Console box carpet
- (b) Lower rear console box
- (c) Rear console armrest
- (d) No. 3 console box mounting bracket
- (e) Console box
- (f) No. 1 console box duct
- (g) No. 7 heater to register

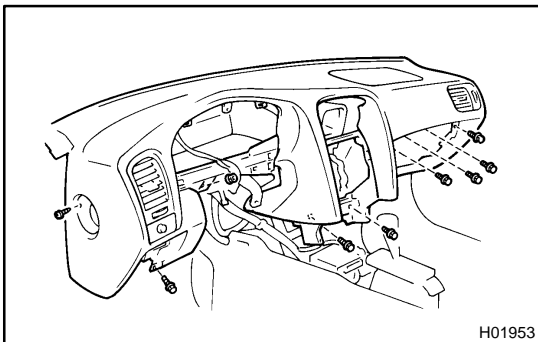
**21. REMOVE INSTRUMENT PANEL SAFETY PAD**

- (a) Remove the 5 bolts and nut and screw.
- (b) Remove the instrument panel safety pad.

22. REMOVE THESE PARTS:

- (a) No. 1 Brace
- (b) No. 2 Brace

23. REMOVE REINFORCEMENT

- (a) Remove the 5 nuts and 4 bolts.
- (b) Remove the reinforcement.

24. REMOVE LOWER DEFROSTER NOZZLE